

Selection Guide

HHD-BPT, DIN Style, Current-Limiting, Back-Up, Potential Transformer Protection

Current ratings [A]: 0.5, 1, 2, 2.5, 3.15, 4, 5

E=192mm	Page	E=292mm	Page	E=367mm	Page	E=442mm	Page	E=537mm	Page
3 / 7.2kV									
3000211.0.5 - 5	74	3009813.2 - 5	74						
3000213.2 - 5	74								
6 / 12kV									
3011911.0.5 - 5	75	3000411.0.5 - 5	75						
3011913.2 - 5	75	3000413.2 - 5	75						
10 / 17.5kV									
3017911.0.5 - 5	76	3025511.0.5 - 5	76	3017611.0.5 - 5	77				
3017913.2 - 5	76	3025513.2 - 5	76	3017613.2 - 5	77				
		3022111.0.5 - 5	77						
		3022113.2 - 5	77						
10 / 24kV									
		3018011.0.5 - 5	78			3000611.0.5 - 5	78		
		3018013.2 - 5	78			3000613.2 - 5	78		
20 / 36kV									
		3038211.0.5 - 5	79			3018111.0.5 - 5	80	3000811.0.5 - 5	80
		3038213.2 - 5	79			3018113.2 - 5	80	3000813.2 - 5	80
38.5kV									
								3033711.0.5 - 5	81
								3033713.2 - 5	81
40.5kV									
								3034011.0.5 - 5	82
								3034013.2 - 5	82

HHD-BPT
3/7.2kV - Rated Voltage

High Voltage Current-Limiting Fuses
For Potential Transformers(PT)

Standard(s)
DIN 43 625
IEC 60282-1
VDE 0670 - 4

Size E=192mm/292mm

Class
Back-Up



Rated Current I_n [A]	Article Number	Diameter D	Weight [kg/1]	Rated Breaking Current I_1 [kA]	Minimum Breaking Current I_3 [A]	Pre-arcing I^2t [A ² s]	Total I^2t @		Power Loss [W]	Cold Resistance [mΩ]
		[in/mm]					0.87U _n (Min) [A ² s]	0.87U _n (Max) [A ² s]		
E=192mm W/O Striker										
0.5	3000211.0.5	2.09 / 53	1.2	63	5	1.6	3.2	5.9	3.6	13 250
1	3000211.1	2.09 / 53	1.2	63	8	0.63	1.8	2.8	2.8	2 100
2	3000211.2	2.09 / 53	1.2	63	16	3.2	9.8	12	5.0	935
2.5	3000211.2.5	2.09 / 53	1.2	63	20	7.2	14.5	22	5.2	630
3.15	3000211.3.15	2.09 / 53	1.2	63	24	17	32	48	5.5	420
4	3000211.4	2.09 / 53	1.2	63	32	31	62	90	7.2	310
5	3000211.5	2.09 / 53	1.2	63	40	40	80	125	5.0	141
E-192mm With 80N Striker										
2	3000213.2	2.09 / 53	1.2	63	16	3.2	9.8	12	5.0	935
2.5	3000213.2.5	2.09 / 53	1.2	63	20	7.2	14.5	22	5.2	630
3.15	3000213.3.15	2.09 / 53	1.2	63	24	17	32	48	5.5	420
4	3000213.4	2.09 / 53	1.2	63	32	31	62	90	7.2	310
5	3000213.5	2.09 / 53	1.2	63	40	40	80	125	5.0	141
E=292mm With 80N Striker										
2	3009813.2	2.09 / 53	1.6	63	16	3.2	9.8	12	5.0	935
2.5	3009813.2.5	2.09 / 53	1.6	63	20	7.2	14.5	22	5.2	630
3.15	3009813.3.15	2.09 / 53	1.6	63	24	17	32	48	5.5	420
4	3009813.4	2.09 / 53	1.6	63	32	31	62	90	7.2	310
5	3009813.5	2.09 / 53	1.6	63	40	40	80	125	5.0	141

Accessories

Article Description	E=192mm	E=292mm	Page(s)
Fuse Base, Indoor	3100102	3100302	98
Fuse Base, Outdoor	3100201	3100401	99
Clips	3100302.20		100
Clips w/Connecting Bar	3400201		100
Microswitch fittings	250mm - 3100116, 660mm - 3100110, 900mm - 3100114, 1200mm - 3100117		97

Dimensions [mm]

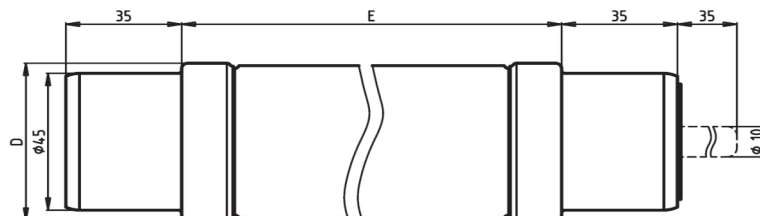

SIBA LLC

29 Fairfield Place
West Caldwell, New Jersey 07006

e-mail: info@sibafuse.com
www.siba-fuses.us

HHD-BPT
6/12kV - Rated Voltage

High Voltage Current-Limiting Fuses
For Potential Transformers(PT)

Standard(s)
DIN 43 625
IEC 60282-1
VDE 0670 - 4

Size E=192mm/292mm

Class
Back-Up



Rated Current I_n [A]	Article Number	Diameter D	Weight [kg/1]	Rated Breaking Current I_1 [kA]	Minimum Breaking Current I_3 [A]	Pre-arcing I^2t [A ² s]	Total I^2t @		Power Loss [W]	Cold Resistance [mΩ]
		[in/mm]					0.87U _n (Min) [A ² s]	0.87U _n (Max) [A ² s]		
E=192mm W/O Striker										
0.5	3011911.0.5	2.09 / 53	1.2	63	5	1.6	3.2	5.9	6.1	22 130
1	3011911.1	2.09 / 53	1.2	63	8	0.63	1.2	1.8	4.8	3 510
2	3011911.2	2.09 / 53	1.2	63	16	3.2	6.5	9.8	8.2	1 570
2.5	3011911.2.5	2.09 / 53	1.2	63	20	7.2	15	23	8.9	950
3.15	3011911.3.15	2.09 / 53	1.2	63	24	17	32	48	9.6	700
4	3011911.4	2.09 / 53	1.2	63	32	31	62	90	12	520
5	3011911.5	2.09 / 53	1.2	63	40	40	80	125	8.3	236
E-192mm With 80N Striker										
2	3011913.2	2.09 / 53	1.2	63	16	3.2	6.5	9.8	8.2	1 570
2.5	3011913.2.5	2.09 / 53	1.2	63	20	7.2	15	23	8.9	950
3.15	3011913.3.15	2.09 / 53	1.2	63	24	17	32	48	9.6	700
4	3011913.4	2.09 / 53	1.2	63	32	31	62	90	12	520
5	3011913.5	2.09 / 53	1.2	63	40	40	80	125	8.3	236
E=292mm W/O Striker										
0.5	3000411.0.5	2.09 / 53	1.6	63	5	1.6	3.2	5.9	6.1	22 130
1	3000411.1	2.09 / 53	1.6	63	8	0.63	1.2	1.8	4.8	3 510
2	3000411.2	2.09 / 53	1.6	63	16	3.2	6.5	9.8	8.2	1 570
2.5	3000411.2.5	2.09 / 53	1.6	63	20	7.2	15	23	8.9	950
3.15	3000411.3.15	2.09 / 53	1.6	63	24	17	32	48	9.6	700
4	3000411.4	2.09 / 53	1.6	63	32	31	62	90	12	520
5	3000411.5	2.09 / 53	1.6	63	40	40	80	125	8.3	236
E=292mm With 80N Striker										
2	3000413.2	2.09 / 53	1.6	63	16	3.2	6.5	9.8	8.2	1 570
2.5	3000413.2.5	2.09 / 53	1.6	63	20	7.2	15	23	8.9	950
3.15	3000413.3.15	2.09 / 53	1.6	63	24	17	32	48	9.6	700
4	3000413.4	2.09 / 53	1.6	63	32	31	62	90	12	520
5	3000413.5	2.09 / 53	1.6	63	40	40	80	125	8.3	236

Accessories

Article Description	E=192mm	E=292mm	Page(s)
Fuse Base, Indoor	Contact SIBA	3100302	98
Fuse Base, Outdoor	Contact SIBA	3100401	99
Clips	3100302.20		100
Clips w/Connecting Bar	3400201		100
Microswitch fittings	250mm - 310116, 660mm - 3100110, 900mm - 3100114, 1200mm - 3100117		97

Dimensions [mm]

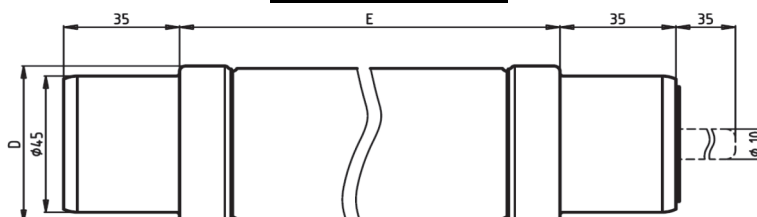

HHD-BPT
10/17.5kV - Rated Voltage

High Voltage Current-Limiting Fuses
For Potential Transformers(PT)

Standard(s)
DIN 43 625
IEC 60282-1
VDE 0670 - 4

Size E=192mm/292mm

Class
Back-Up



Rated Current I_n [A]	Article Number	Diameter D	Weight [kg/1]	Rated Breaking Current I_1 [kA]	Minimum Breaking Current I_3 [A]	Pre-arcing I^2t [A ² s]	Total I^2t @		Power Loss [W]	Cold Resistance [mΩ]
		[in/mm]					0.87U _n (Min) [A ² s]	0.87U _n (Max) [A ² s]		
E=192mm W/O Striker										
0.5	3017911.0.5	2.09 / 53	1.2	63	5	1.6	3.2	5.9	8.1	29 480
1	3017911.1	2.09 / 53	1.2	63	8	0.63	1.2	1.8	6.2	4 640
2	3017911.2	2.09 / 53	1.2	63	16	3.2	6.5	9.8	11	2 060
2.5	3017911.2.5	2.09 / 53	1.2	63	20	7.2	17	24	12	1 400
3.15	30 7911.3.15	2.09 / 53	1.2	63	24	17	32	48	13	920
4	3017911.4	2.09 / 53	1.2	63	32	31	62	90	16	690
5	3017911.5	2.09 / 53	1.2	63	40	40	80	125	11	314
E-192mm With 80N Striker										
2	3017913.2	2.09 / 53	1.2	63	16	3.2	6.5	9.8	11	2 060
2.5	3017913.2.5	2.09 / 53	1.2	63	20	7.2	17	24	12	1 400
3.15	3017913.3.15	2.09 / 53	1.2	63	24	17	32	48	13	920
4	3017913.4	2.09 / 53	1.2	63	32	31	62	90	16	690
5	3017913.5	2.09 / 53	1.2	63	40	40	80	125	11	314
E=292mm W/O Striker										
0.5	3025511.0.5	2.09 / 53	1.6	63	5	1.6	3.2	5.9	8.1	29 480
1	30255 1.1	2.09 / 53	1.6	63	8	0.63	1.2	1.8	6.2	4 640
2	3025511.2	2.09 / 53	1.6	63	16	3.2	6.5	9.8	11	2 060
2.5	3025511.2.5	2.09 / 53	1.6	63	20	7.2	17	24	12	1 400
3.15	3025511.3.15	2.09 / 53	1.6	63	24	17	32	48	13	920
4	3025511.4	2.09 / 53	1.6	63	32	31	62	90	16	690
5	3025511.5	2.09 / 53	1.6	63	40	40	80	125	11	314
E=292mm With 80N Striker										
2	3025513.2	2.09 / 53	1.6	63	16	3.2	6.5	9.8	11	2 060
2.5	3025513.2.5	2.09 / 53	1.6	63	20	7.2	17	24	12	1 400
3.15	3025513.3.15	2.09 / 53	1.6	63	24	17	32	48	13	920
4	3025513.4	2.09 / 53	1.6	63	32	31	62	90	16	690
5	3025513.5	2.09 / 53	1.6	63	40	40	80	125	11	314

Accessories

Article Description	E=192mm	E=292mm	Page(s)
Fuse Base, Indoor	Contact SIBA	3122101	98
Fuse Base, Outdoor	Contact SIBA	Contact SIBA	99
Clips	3100302.20		100
Clips w/Connecting Bar	3400201		100
Microswitch fittings	250mm - 3100116, 660mm - 3100110, 900mm - 3100114, 1200mm - 3100117		97

Dimensions [mm]

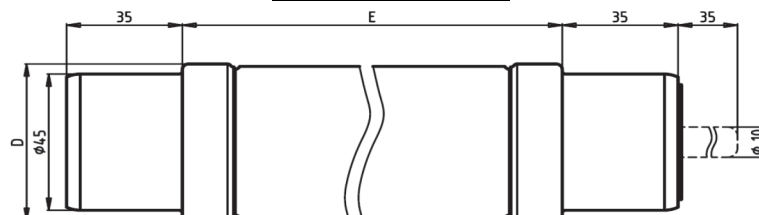

SIBA LLC

Phone 1-973-575-7422
Fax 1-973-575-5858

29 Fairfield Place
West Caldwell, New Jersey 07006

e-mail: info@sibafuse.com
www.siba-fuses.us

HHD-BPT
10/17.5kV - Rated Voltage

High Voltage Current-Limiting Fuses
For Potential Transformers(PT)

Standard(s)
DIN 43 625
IEC 60282-1
VDE 0670 - 4

Size E=292mm/367mm

**Class
Back-Up**



Rated Current I_n [A]	Article Number	Diameter D	Weight [kg/1]	Rated Breaking Current I_1 [kA]	Minimum Breaking Current I_3 [A]	Pre-arcing I^2t [A ² s]	Total I^2t @		Power Loss [W]	Cold Resistance [mΩ]
		[in/mm]					0.87U _n (Min) [A ² s]	0.87U _n (Max) [A ² s]		
E=292mm W/O Striker										
0.5	3022111.0.5	2.64 / 67	2.6	63	5	1.6	3.2	5.9	8.1	29 480
1	3022111.1	2.64 / 67	2.6	63	8	0.63	1.2	1.8	6.2	4 640
2	3022111.2	2.64 / 67	2.6	63	16	3.2	6.5	9.8	11	2 060
2.5	3022111.2.5	2.64 / 67	2.6	63	20	7.2	17	24	12	1 400
3.15	3022111.3.15	2.64 / 67	2.6	63	24	17	32	48	13	920
4	3022111.4	2.64 / 67	2.6	63	32	31	62	90	16	690
5	3022111.5	2.64 / 67	2.6	63	40	40	80	125	11	314
E-292mm With 80N Striker										
2	3022113.2	2.64 / 67	2.6	63	16	3.2	6.5	9.8	11	2 060
2.5	3022113.2.5	2.64 / 67	2.6	63	20	7.2	17	24	12	1 400
3.15	3022113.3.15	2.64 / 67	2.6	63	24	17	32	48	13	920
4	3022113.4	2.64 / 67	2.6	63	32	31	62	90	16	690
5	3022113.5	2.64 / 67	2.6	63	40	40	80	125	11	314
E=367mm W/O Striker										
0.5	3017611.0.5	2.09 / 53	2.0	63	5	1.6	3.2	5.9	8.1	29 480
1	3017611.1	2.09 / 53	2.0	63	8	0.63	1.2	1.8	6.2	4 640
2	3017611.2	2.09 / 53	2.0	63	16	3.2	6.5	9.8	11	2 060
2.5	3017611.2.5	2.09 / 53	2.0	63	20	7.2	17	24	12	1 400
3.15	3017611.3.15	2.09 / 53	2.0	63	24	17	32	48	13	920
4	3017611.4	2.09 / 53	2.0	63	32	31	62	90	16	690
5	3017611.5	2.09 / 53	2.0	63	40	40	80	125	11	314
E=367mm With 80N Striker										
2	3017613.2	2.09 / 53	2.0	63	16	3.2	6.5	9.8	11	2 060
2.5	3017613.2.5	2.09 / 53	2.0	63	20	7.2	17	24	12	1 400
3.15	3017613.3.15	2.09 / 53	2.0	63	24	17	32	48	13	920
4	3017613.4	2.09 / 53	2.0	63	32	31	62	90	16	690
5	3017613.5	2.09 / 53	2.0	63	40	40	80	125	11	314

Accessories

Article Description	E=292mm	E=357mm	Page(s)
Fuse Base, Indoor	3122101	Contact SIBA	98
Fuse Base, Outdoor	Contact SIBA	Contact SIBA	99
Clips	3100302.20		100
Clips w/Connecting Bar	3400201		100
Microswitch fittings	250mm - 3100116, 660mm - 3100110, 900mm - 3100114, 1200mm - 3100117		97

Dimensions [mm]

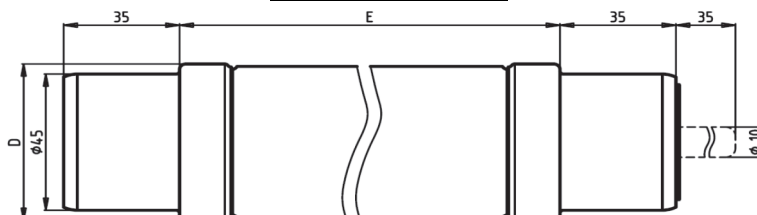

HHD-BPT
10/24kV - Rated Voltage

High Voltage Current-Limiting Fuses
For Potential Transformers(PT)

Standard(s)
DIN 43 625
IEC 60282-1
VDE 0670 - 4

Size E=292mm/442mm

**Class
Back-Up**



Rated Current I_n [A]	Article Number	Diameter D	Weight [kg/1]	Rated Breaking Current I_1 [kA]	Minimum Breaking Current I_3 [A]	Pre-arcing I^2t [A ² s]	Total I^2t @		Power Loss [W]	Cold Resistance [mΩ]
		[in/mm]					0.87U _n (Min) [A ² s]	0.87U _n (Max) [A ² s]		
E=292mm W/O Striker										
0.5	3018011.0.5	2.09 / 53	2.0	63	5	1.6	3.2	5.9	11.2	40 550
1	3018011.1	2.09 / 53	2.0	63	8	0.63	1.2	1.8	8.6	6 450
2	3018011.2	2.09 / 53	2.0	63	16	3.2	6.5	9.8	15	2 850
2.5	3018011.2.5	2.09 / 53	2.0	63	20	7.2	19	26	16	1 920
3.15	3018011.3.15	2.09 / 53	2.0	63	24	17	32	48	18	1 300
4	3018011.4	2.09 / 53	2.0	63	32	31	62	90	22	950
5	30180 1.5	2.09 / 53	2.0	63	40	40	80	125	15	433
E-292mm With 80N Striker										
2	3018013.2	2.09 / 53	2.0	63	16	3.2	6.5	9.8	15	2 850
2.5	3018013.2.5	2.09 / 53	2.0	63	20	7.2	19	26	16	1 920
3.15	3018013.3.15	2.09 / 53	2.0	63	24	17	32	48	18	1 300
4	3018013.4	2.09 / 53	2.0	63	32	31	62	90	22	950
5	3018013.5	2.09 / 53	2.0	63	40	40	80	125	15	433
E=442mm W/O Striker										
0.5	3000611.0.5	2.09 / 53	2.3	63	5	1.6	3.2	5.9	11.2	6 450
1	3000611.1	2.09 / 53	2.3	63	8	0.63	1.2	1.8	8.6	2 850
2	3000611.2	2.09 / 53	2.3	63	16	3.2	6.5	9.8	15	1 920
2.5	3000611.2.5	2.09 / 53	2.3	63	20	7.2	19	26	16	1 300
3.15	3000611.3.15	2.09 / 53	2.3	63	24	17	32	48	18	950
4	3000611.4	2.09 / 53	2.3	63	32	31	62	90	22	433
5	3000611.5	2.09 / 53	2.3	63	40	40	80	125	15	314
E=442mm With 80N Striker										
2	3000613.2	2.09 / 53	2.3	63	16	3.2	6.5	9.8	15	2 850
2.5	3000613.2.5	2.09 / 53	2.3	63	20	7.2	19	26	16	1 920
3.15	3000613.3.15	2.09 / 53	2.3	63	24	17	32	48	18	1 300
4	3000613.4	2.09 / 53	2.3	63	32	31	62	90	22	950
5	3000613.5	2.09 / 53	2.3	63	40	40	80	125	15	433

Accessories

Article Description	E=292mm	E=442mm	Page(s)
Fuse Base, Indoor	3122101	3100502	98
Fuse Base, Outdoor	Contact SIBA	3100601	99
Clips	3100302.20		100
Clips w/Connecting Bar	3400201		100
Microswitch fittings	250mm - 3100116, 660mm - 3100110, 900mm - 3100114, 1200mm - 3100117		97

Dimensions [mm]

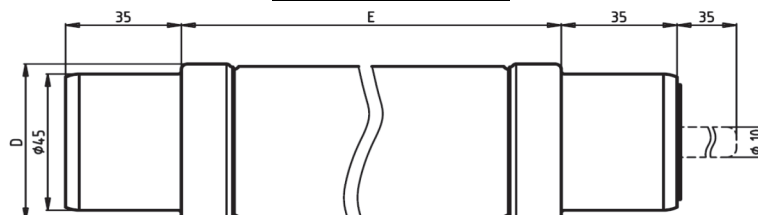

SIBA LLC

Phone 1-973-575-7422
Fax 1-973-575-5858

29 Fairfield Place
West Caldwell, New Jersey 07006

e-mail: info@sibafuse.com
www.siba-fuses.us

HHD-BPT
20/36kV - Rated Voltage

High Voltage Current-Limiting Fuses
For Potential Transformers (PT)

Standard(s)
DIN 43 625
IEC 60282-1
VDE 0670 - 4

Size E=292mm

Class
Back-Up



Rated Current I_n [A]	Article Number	Diameter D	Weight [kg/1]	Rated Breaking Current I_1 [kA]	Minimum Breaking Current I_3 [A]	Pre-arcing I^2t [A ² s]	Total I^2t @		Power Loss [W]	Cold Resistance [mΩ]
		[in/mm]					0.87U _n (Min) [A ² s]	0.87U _n (Max) [A ² s]		
E=292mm W/O Striker										
0.5	3038211.0.5	2.09 / 53	2.0	40	5	1.6	3.2	5.9	17	60 800
1	3038211.1	2.09 / 53	2.0	40	8	0.63	1.2	1.8	13	9 570
2	3038211.2	2.09 / 53	2.0	40	16	3.2	6.5	9.8	23	4 260
2.5	3038211.2.5	2.09 / 53	2.0	40	20	7.2	21	35	22	2 600
3.15	3038211.3.15	2.09 / 53	2.0	40	24	17	32	48	26	1 900
4	3038211.4	2.09 / 53	2.0	40	32	31	62	90	33	1 420
5	3038211.5	2.09 / 53	2.0	40	40	40	80	125	23	650
E-292mm With 80N Striker										
2	3038213.2	2.09 / 53	2.0	40	16	3.2	6.5	9.8	23	4 260
2.5	3038213.2.5	2.09 / 53	2.0	40	20	7.2	21	35	22	2 600
3.15	3038213.3.15	2.09 / 53	2.0	40	24	17	32	48	26	1 900
4	3038213.4	2.09 / 53	2.0	40	32	31	62	90	33	1 420
5	3038213.5	2.09 / 53	2.0	40	40	40	80	125	23	650

Accessories

Article Description	E=292mm	Page(s)
Fuse Base, Indoor	Contact SIBA	98
Fuse Base, Outdoor	Contact SIBA	99
Clips	3100302.20	100
Clips w/Connecting Bar	3400201	100
Microswitch fittings	250mm - 3100116, 660mm - 3100110, 900mm - 3100114, 1200mm - 3100117	97

Dimensions [mm]

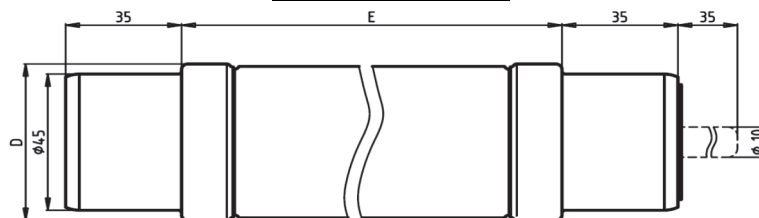

HHD-BPT
20/36kV - Rated Voltage

High Voltage Current-Limiting Fuses
For Potential Transformers(PT)

Standard(s)
DIN 43 625
IEC 60282-1
VDE 0670 - 4

Size E=442mm/537mm

**Class
Back-Up**



Rated Current I_n [A]	Article Number	Diameter D	Weight [kg/1]	Rated Breaking Current I_1 [kA]	Minimum Breaking Current I_3 [A]	Pre-arcing I^2t [A ² s]	Total I^2t @		Power Loss [W]	Cold Resistance [mΩ]
		[in/mm]					0.87U _n (Min) [A ² s]	0.87U _n (Max) [A ² s]		
E=442mm W/O Striker										
0.5	3018111.0.5	2.09 / 53	2.2	40	5	1.6	3.2	5.9	17	60 800
1	3018111.1	2.09 / 53	2.2	40	8	0.63	1.2	1.8	13	9 570
2	3018111.2	2.09 / 53	2.2	40	16	3.2	6.5	9.8	23	4 260
2.5	3018111.2.5	2.09 / 53	2.2	40	20	7.2	21	35	22	2 600
3.15	3018111.3.15	2.09 / 53	2.2	40	24	17	32	48	26	1 900
4	3018111.4	2.09 / 53	2.2	40	32	31	62	90	33	1 420
5	3018111.5	2.09 / 53	2.2	40	40	40	80	125	23	650
E-442mm With 80N Striker										
2	3018113.2	2.09 / 53	2.2	40	16	3.2	6.5	9.8	23	4 260
2.5	3018113.2.5	2.09 / 53	2.2	40	20	7.2	21	35	22	2 600
3.15	3018113.3.15	2.09 / 53	2.2	40	24	17	32	48	26	1 900
4	3018113.4	2.09 / 53	2.2	40	32	31	62	90	33	1 420
5	3018113.5	2.09 / 53	2.2	40	40	40	80	125	23	650
E=537mm W/O Striker										
0.5	3000811.0.5	2.09 / 53	2.7	40	5	1.6	3.2	5.9	17	60 800
1	3000811.1	2.09 / 53	2.7	40	8	0.63	1.2	1.8	13	9 570
2	3000811.2	2.09 / 53	2.7	40	16	3.2	6.5	9.8	23	4 260
2.5	3000811.2.5	2.09 / 53	2.7	40	20	7.2	21	35	22	2 600
3.15	3000811.3.15	2.09 / 53	2.7	40	24	17	32	48	26	1 900
4	3000811.4	2.09 / 53	2.7	40	32	31	62	90	33	1 420
5	3000811.5	2.09 / 53	2.7	40	40	40	80	125	23	650
E-537mm With 80N Striker										
2	3000813.2	2.09 / 53	2.7	40	16	3.2	6.5	9.8	23	4 260
2.5	3000813.2.5	2.09 / 53	2.7	40	20	7.2	21	35	22	2 600
3.15	3000813.3.15	2.09 / 53	2.7	40	24	17	32	48	26	1 900
4	3000813.4	2.09 / 53	2.7	40	32	31	62	90	33	1 420
5	3000813.5	2.09 / 53	2.7	40	40	40	80	125	23	650

Accessories

Article Description	E=442mm	E=537mm	Page(s)
Fuse Base, Indoor	Contact SIBA	31 007 02	98
Fuse Base, Outdoor	Contact SIBA	31 008 01	99
Clips	3100302.20		100
Clips w/Connecting Bar	3400201		100
Microswitch fittings	250mm - 3100116, 660mm - 3100110, 900mm - 3100114, 1200mm - 31001 7		97

Dimensions [mm]

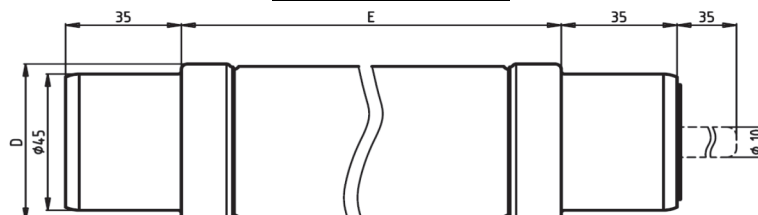

SIBA LLC

Phone 1-973-575-7422
Fax 1-973-575-5858

29 Fairfield Place
West Caldwell, New Jersey 07006

e-mail: info@sibafuse.com
www.siba-fuses.us

HHD-BPT
38.5kV - Rated Voltage

High Voltage Current-Limiting Fuses
For Potential Transformers(PT)

Standard(s)
DIN 43 625
IEC 60282-1
VDE 0670 - 4

Size E=537mm

**Class
Back-Up**



Rated Current I_n [A]	Article Number	Diameter D	Weight [kg/1]	Rated Breaking Current I_1 [kA]	Minimum Breaking Current I_3 [A]	Pre-arcing I^2t [A ² s]	Total I^2t		Power Loss [W]	Cold Resistance [mΩ]
		[in/mm]					0.87U(Min) [A ² s]	0.87U _n (Max) [A ² s]		
E=537mm W/O Striker										
0.5	3033711.0.5	2.09 / 53	2.7	40	5	1.6	3.2	5.9	23	64 800
1	3033711.1	2.09 / 53	2.7	40	8	0.63	1.2	1.8	14	10 200
2	3033711.2	2.09 / 53	2.7	40	16	3.2	6.5	9.8	25	4 500
2.5	3033711.2.5	2.09 / 53	2.7	40	20	7.2	21	35	27	3 050
3.15	3033711.3.15	2.09 / 53	2.7	40	24	17	32	48	30	2 150
4	3033711.4	2.09 / 53	2.7	40	32	31	62	90	35	1 550
5	3033711.5	2.09 / 53	2.7	40	40	40	80	125	44	1 250
E-537mm With 80N Striker										
2	3033713.2	2.09 / 53	2.7	40	16	3.2	6.5	9.8	25	4 500
2.5	3033713.2.5	2.09 / 53	2.7	40	20	7.2	21	35	27	3 050
3.15	3033713.3.15	2.09 / 53	2.7	40	24	17	32	48	30	2 150
4	3033713.4	2.09 / 53	2.7	40	32	31	62	90	35	1 550
5	3033713.5	2.09 / 53	2.7	40	40	40	80	125	44	1 250

Accessories

Article Description	E=537mm	Page(s)
Fuse Base, Indoor	Contact SIBA	98
Fuse Base, Outdoor	3134001	99
Clips	3100302.20	100
Clips w/Connecting Bar	3400201	100
Microswitch fittings	250mm - 3100116, 660mm - 3100110, 900mm - 3100114, 1200mm - 3100117	97

Dimensions [mm]

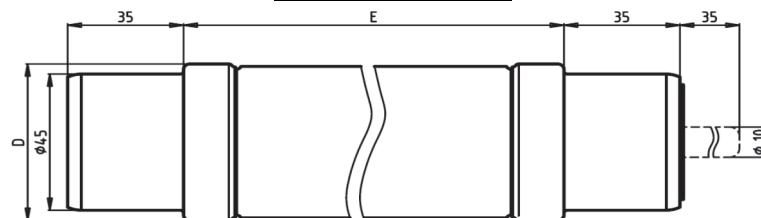

HHD-BPT
40.5kV - Rated Voltage

High Voltage Current-Limiting Fuses
For Potential Transformers(PT)

Standard(s)
DIN 43 625
IEC 60282-1
VDE 0670 - 4

Size E=537mm

**Class
Back-Up**



Rated Current I_n [A]	Article Number	Diameter D	Weight [kg/1]	Rated Breaking Current I_1 [kA]	Minimum Breaking Current I_3 [A]	Pre-arcing I^2t [A ² s]	Total I^2t @		Power Loss [W]	Cold Resistance [mΩ]
		[in/mm]					0.87U(Min) [A ² s]	0.87U _n (Max) [A ² s]		
E=537mm W/O Striker										
0.5	3034011.0.5	2.09 / 53	2.7	40	5	1.6	3.2	5.9	24	64 800
1	3034011.1	2.09 / 53	2.7	40	8	0.63	1.2	1.8	15	10 200
2	3034011.2	2.09 / 53	2.7	40	16	3.2	6.5	9.8	27	4 800
2.5	3034011.2.5	2.09 / 53	2.7	40	20	7.2	21	35	28	3 250
3.15	3034011.3.15	2.09 / 53	2.7	40	24	17	32	48	32	2 270
4	3034011.4	2.09 / 53	2.7	40	32	31	62	90	36	1 620
5	3034011.5	2.09 / 53	2.7	40	40	40	80	125	47	1 340
E-537mm With 80N Striker										
2	3034013.2	2.09 / 53	2.7	40	16	3.2	6.5	9.8	27	4 800
2.5	3034013.2.5	2.09 / 53	2.7	40	20	7.2	21	35	28	3 250
3.15	3034013.3.15	2.09 / 53	2.7	40	24	17	32	48	32	2 270
4	3034013.4	2.09 / 53	2.7	40	32	31	62	90	36	1 620
5	3034013.5	2.09 / 53	2.7	40	40	40	80	125	47	1 340

Accessories

Article Description	E=537mm	Page(s)
Fuse Base, Indoor	Contact SIBA	98
Fuse Base, Outdoor	3134001	99
Clips	3100302.20	100
Clips w/Connecting Bar	3400201	100
Microswitch fittings	250mm - 3100116, 660mm - 3100110, 900mm - 3100114, 1200mm - 3100117	97

Dimensions [mm]

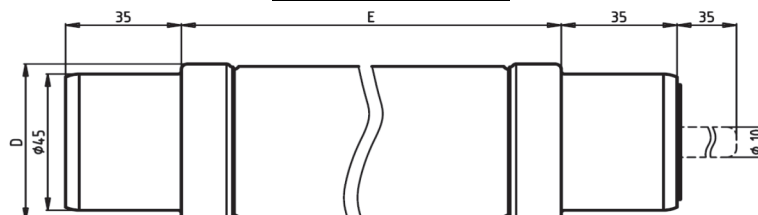

SIBA LLC

Phone 1-973-575-7422
Fax 1-973-575-5858

29 Fairfield Place
West Caldwell, New Jersey 07006

e-mail: info@sibafuse.com
www.siba-fuses.us

HHD-BPT Time-Current Characteristics - Average Melting Cut-Off Current Diagram Current-Limiting, Back-Up, 3/7.2kV - 40.5kV, (0.5A - 5A)

30xxx11.0.5 - 5; xxx = 002, 004, 006, 008, - , 119, 176, 179, 180, 181, 221, 255, 282, 337, 340
 30xxx13.2 - 5; xxx = 002, 004, 006, 008, 098, 119, 176, 179, 180, 181, 221, 255, 282, 337, 340
Average Melting

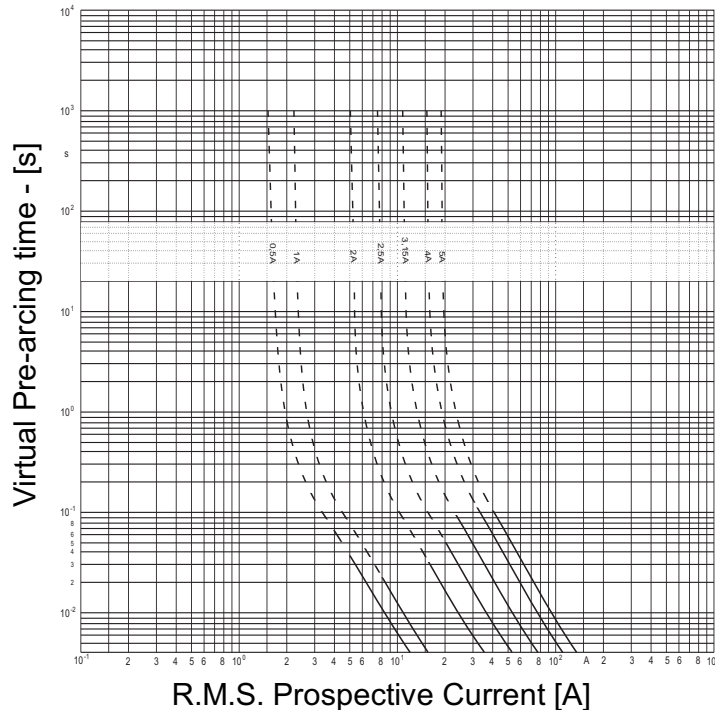

Cut-Off Current

